

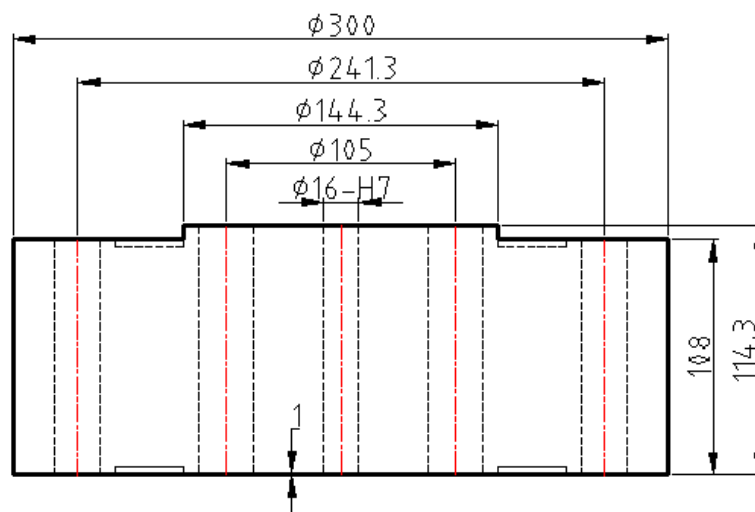

DESCRIPTION

High quality alloy steel, easy to install, protected against corrosion nickel plated treatment, suitable for testing machines.

OUTLINE DIMENSIONS in millimeters (mm)

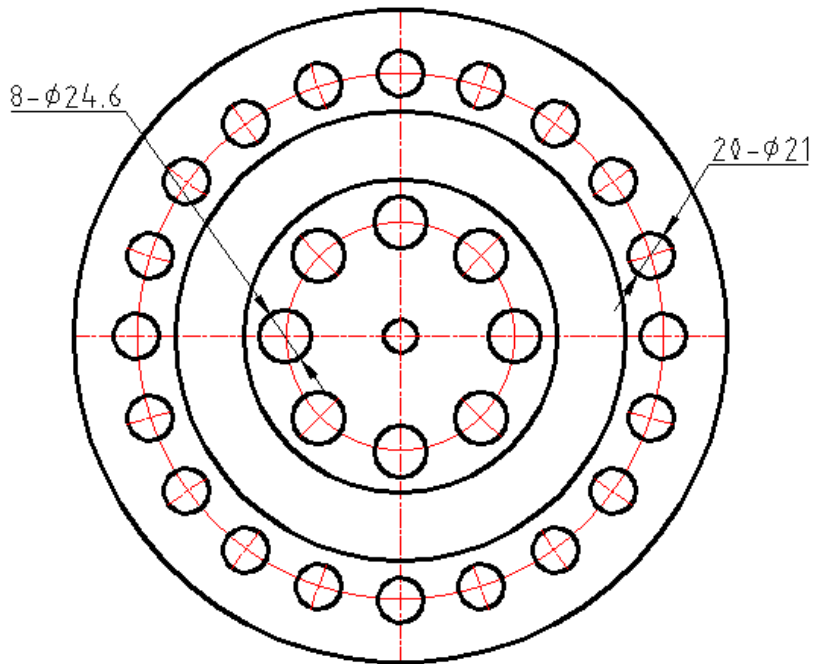

SPECIFICATIONS

Capacity	kN	1000
Rated output	mv/v	4.0 ± 0.1%
Non-linearity	%F.S	0.05~0.08
Hysteresis	%F.S	0.05~0.08
Creep in 30 minutes	%F.S	0.05
Zero balance	%F.S	± 1
Input resistance	Ω	385 ± 15
Output resistance	Ω	350 ± 3
Insulation resistance	MΩ	≥ 5000
Excitation voltage	V	10V (maximum 15V) AC/DC
Environmental protection		IP67
Safe overload	%F.S	150
Ultimate overload	%F.S	300
Operating temperature range	°C	-10 ~ +40
Material		Alloy steel & Stainless steel
Cable Length	m	5

FEATURE

- Axle-load scale, warehouse scale, experimental machine

Wiring Schematic Diagram

