

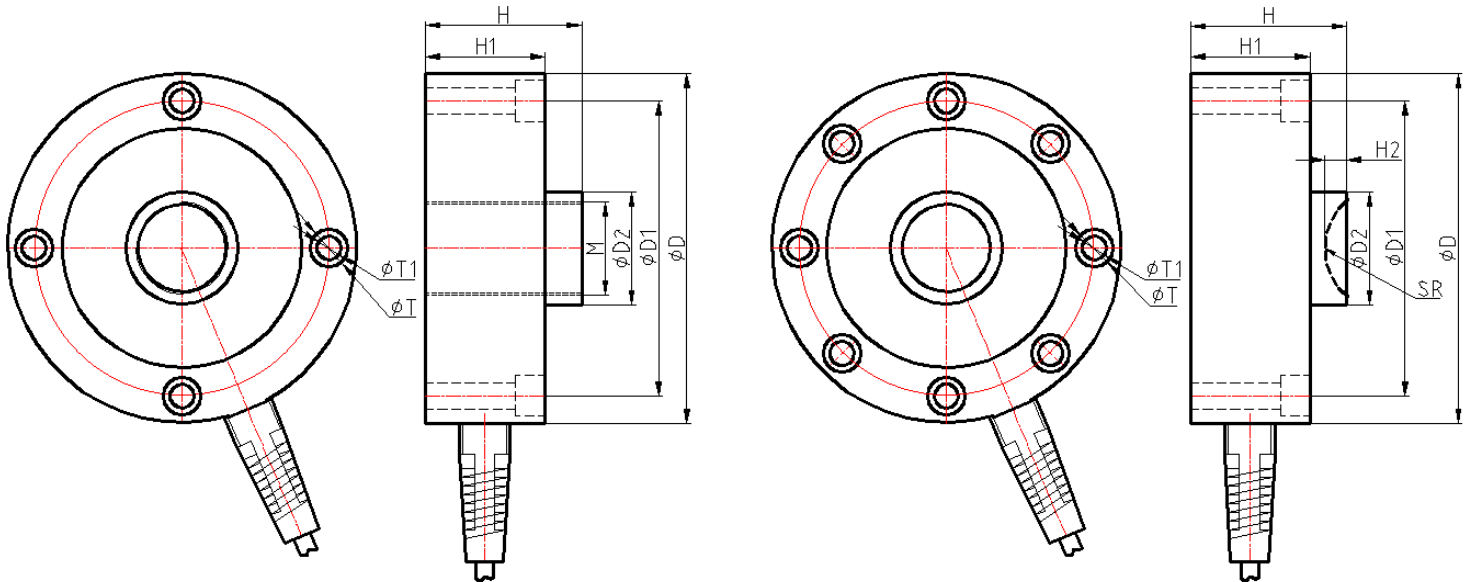

DESCRIPTION

Electroless nickel plated alloy tool steel, compact size with low profile. Be suitable for truck, rail scales, silo/hopper/tank weighing, tensile/pulling force measurement, universal material tester.

OUTLINE DIMENSIONS in millimeters (mm)



Capacity	Size mm									
Klb	D	D1	D2	H	H1	H2	M	T	T1	SR
5/10	104.7	88.9	32	34.8	31.75	--	5/8-18UNF	8-Φ7.2	10.5 × 7.2DP	--
25/50	120.7	101.6	38.9	53.8	41.1	7.6	--	4-Φ8.7	13.5 × 9.7DP	22.2
100	138	116.8	50.4	57.2	50.8	7.6	--	8-Φ10.13	16.5 × 11DP	22.2

SPECIFICATIONS

Capacity	Klb	5,10,25,50,100
Rated output	mv/v	4.0 ± 0.1%
Non-linearity	%F.S	0.05
Hysteresis	%F.S	0.05
Creep in 30 minutes	%F.S	0.05
Zero balance	%F.S	± 1
Input resistance	Ω	385 ± 5 / 770 ± 10
Output resistance	Ω	350 ± 3 / 700 ± 5
Insulation resistance	MΩ	≥ 5000
Excitation voltage	V	10V (maximum 15V) AC/DC
Environmental protection		IP67
Safe overload	%F.S	150
Ultimate overload	%F.S	300
Operating temperature range	°C	-10 ~ +40
Material		Alloy steel & Stainless steel
Cable Length	m	5

FEATURE

- Axle-load scale, warehouse scale, experimental machine

Wiring Schematic Diagram

