

# LFCS Sensor



## DESCRIPTION

Wheel shaped load cell, shear beam, good rigidity, strong side force resistance, high output, overload self-locking. Potted sealed or hermetically sealed. Widely used in truck scale, railroad scale, tester, crane scale, etc.

## OUTLINE DIMENSIONS in millimeters (mm)

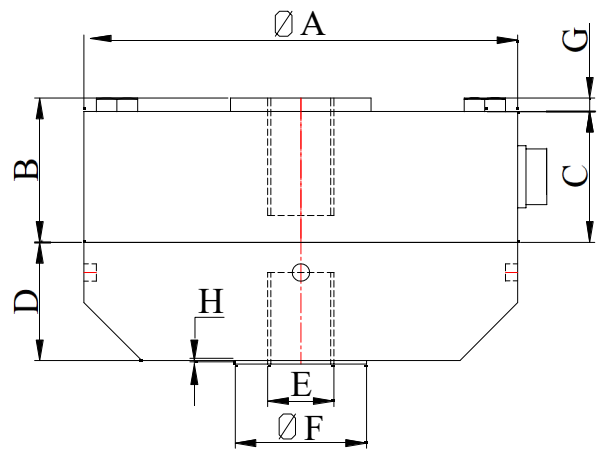
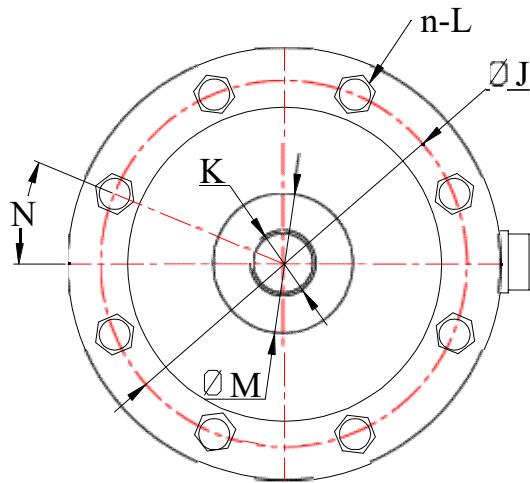

Capacity (klb)	Size mm									
	ΦA	B	C	D	E	ΦF	G	H	ΦJ	K
0.3,0.5,1,2,5,10	104.8	34.9	31.7	28.6	M16×2-4H×22.1	31.8	5.1	0.8	88.9	M16×2-4H×28.4
25,50	153.9	44.5	41.4	44.5	M33×2-4H×35.6	57.2	7.6	0.8	130.3	M33×2-4H×35.6
100	203.2	63.5	57.2	50.8	M42×2-4H×44.5	76.2	10.2	0.8	165.1	M42×2-4H×54.6
Capacity (klb)	Size mm									
	n-L	ΦM	N							
0.3,0.5,1,2,5,10	8×7.1	34	22.5°							
25,50	12×10.4	67.3	15°							
100	16×13.5	95.2	11.25°							

Capacity (klb)	Size inch									
	ΦA	B	C	D	E	ΦF	G	H	ΦJ	K
0.3,0.5,1,2,5,10	4.13	1.38	1.25	1.13	5/8-18UNF-3B×0.87	1.25	0.20	0.03	3.35	5/8-18UNF-3B×1.12
25,50	6.06	1.75	1.63	1.75	1-1/4-12UNF-3B×1.40	2.25	0.30	0.03	5.13	1-1/4-12UNF-3B×1.40
100	8.00	2.50	2.25	2.00	1-3/4-12UNF-3B×1.75	3.00	0.40	0.03	6.50	1-3/4-12UNF-3B×2.15
Capacity (klb)	Size inch									
	n-L	ΦM	N							
0.3,0.5,1,2,5,10	8×0.28	1.34	22.5°							
25,50	12×0.41	2.65	15°							
100	16×0.53	3.67	11.25°							

## SPECIFICATIONS

Capacity	kN	1.5 kN,2.5 kN,5 kN,10 kN,25 kN,50 kN,100 kN,250 kN,450 kN
	klb	0.3 klb,0.5 klb,1 klb,2 klb,5 klb,10 klb,25 klb,50 klb,100 klb
Rated output	mv/v	4.0±0.1% (5~100klb/25~450kN) 2.0±0.1% (0.3~2klb/1.5~10kN)
Non-linearity	%F.S	0.04% Full scale (0.3~2klb/1.5~10kN) 0.05% Full scale (5~100klb/25~450kN)
Hysteresis	%F.S	0.03% Full scale (0.3~2klb/1.5~10kN) 0.05% Full scale (5~100klb/25~50kN) 0.06% Full scale (25~100klb/100~450kN)
Creep in 30 minutes	%F.S	0.03% Full scale (0.3~2klb/1.5~10kN) 0.05% Full scale (5~100klb/25~50kN) 0.06% Full scale (25~100klb/100~450kN)
Zero balance	%F.S	±1
Input resistance	Ω	385±15
Output resistance	Ω	350±3
Insulation resistance	MΩ	≥5000
Excitation voltage	V	10V (maximum 15V) AC/DC
Environmental protection		IP67
Safe overload	%F.S	150
Ultimate overload	%F.S	300
Operating temperature range	°C	-10~+40
Material		Alloy steel & Stainless steel
Cable Length	m	3,6,9

## Wiring Schematic Diagram

