

MZ15 Sensor



DESCRIPTION

Column type, Laser welding pull ,laser welded IP68, fast dynamic response, strong anti-overload capability, upper ball head load bearing; Simple to install, easy to use, Suitable for electronic truck scale, dynamic railroad scale and big capacity hopper scale, etc.

OUTLINE DIMENSIONS in millimeters (mm)

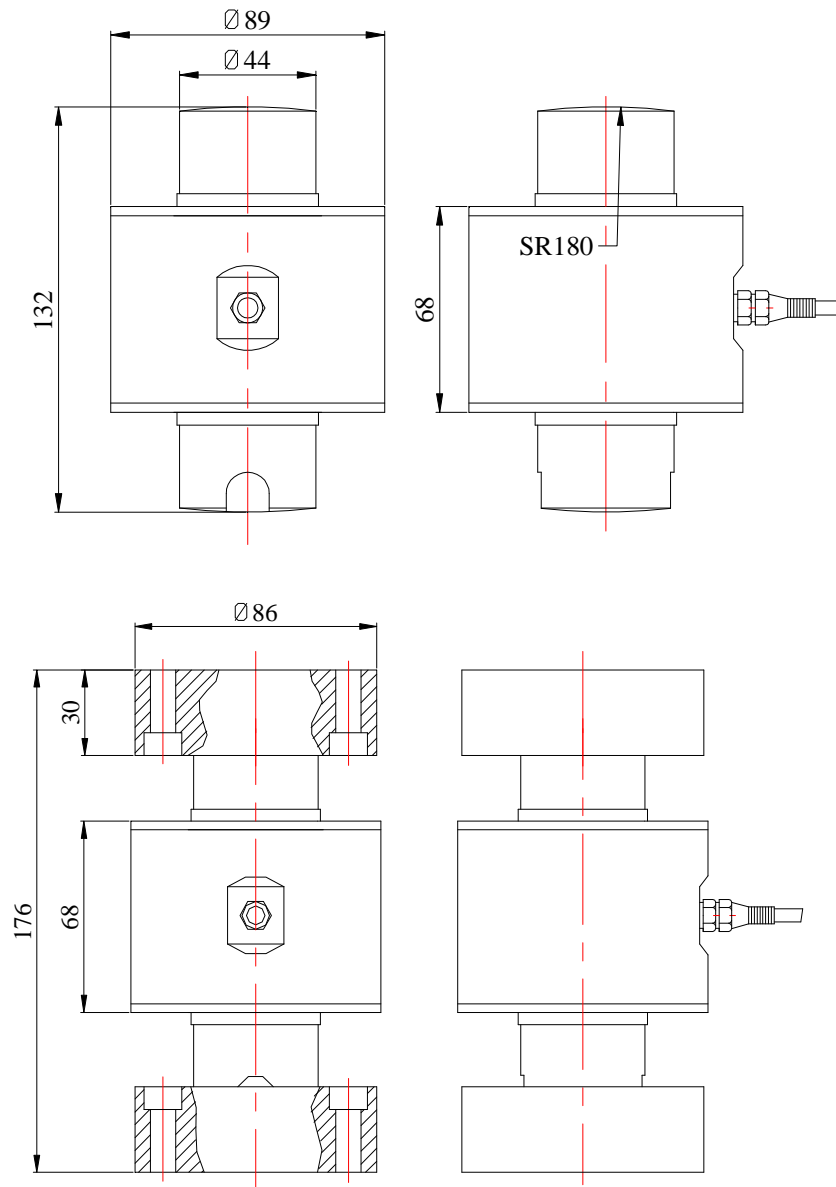

SPECIFICATIONS

Capacity	t	30,40,50,60
Rated output	mv/v	2.0±0.1%
Non-linearity	%F.S	0.03
Hysteresis	%F.S	0.03
Creep in 30 minutes	%F.S	0.03
Zero balance	%F.S	±1
Input resistance	Ω	760±10
Output resistance	Ω	702±3
Insulation resistance	MΩ	≥5000
Excitation voltage	V	10V (maximum 15V) AC/DC
Environmental protection		IP67
Safe overload	%F.S	1 50
Ultimate overload	%F.S	300
Operating temperature range	°C	-10~+40
Material		Alloy steel & Stainless steel
Cable Length	m	6m

Wiring Schematic Diagram

