

MSB1 Sensor

Single-Ended Beam

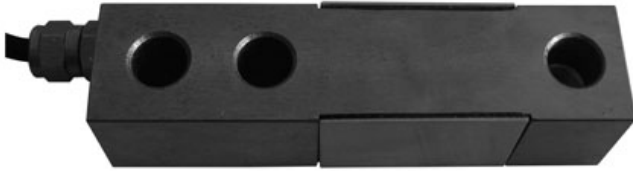

DESCRIPTION

It is a single-ended shear beam sensor designed for multiple cell applications such as low profile platform or small tank scales when used with proper mounting accessories. It is insensitive to side loading and capable of reversed loading.

OUTLINE DIMENSIONS in millimeters (mm)

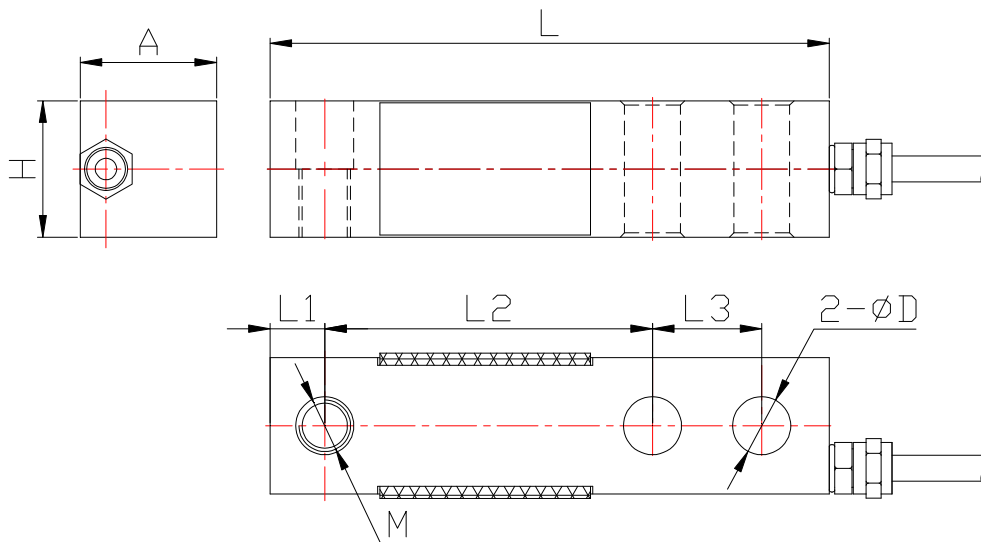

Capacity	Size mm(inch)							
	L	L1	L2	L3	H	A	ΦD	M
250kg	130 (5.12)	12.7 (0.50)	76.2 (3.00)	25.4 (1.00)	25.4 (1.00)	31.7 (1.25)	13.5 (0.53)	M12×1.75
500lb	130 (5.12)	12.7 (0.50)	76.2 (3.00)	25.4 (1.00)	25.4 (1.00)	31.7 (1.25)	13.5 (0.53)	1/2-20UNF
500,1000,1500,2000kg	130 (5.12)	12.7 (0.50)	76.2 (3.00)	25.4 (1.00)	31.7 (1.25)	31.7 (1.25)	13.5 (0.53)	M12×1.75
1K,2K,2.5K,3K,4K, 5KSElb	130 (5.12)	12.7 (0.50)	76.2 (3.00)	25.4 (1.00)	31.7 (1.25)	31.7 (1.25)	13.5 (0.53)	1/2-20UNF
2500.5000kg	171.5 (6.75)	19.0 (0.75)	95.3 (3.75)	38.1 (1.50)	38.1 (1.50)	38.1 (1.50)	19.8 (0.78)	M20×1.5
5K.10Klb	171.5 (6.75)	19.0 (0.75)	95.3 (3.75)	38.1 (1.50)	38.1 (1.50)	38.1 (1.50)	19.8 (0.78)	3/4-16UNF
15K,20Klb	225.6 (8.88)	25.4 (1.00)	123.9 (4.88)	50.8 (2.00)	50.8 (2.00)	50.8 (2.00)	26.2 (1.03)	1-14UNS

SPECIFICATIONS

Capacity	kg lb	250, 500, 1000, 1500, 2000, 2500, 5000 500, 1K, 2K, 3K, 4K, 5K, 10K, 15K, 20K
Rated output	mv/v	3.0±0.002
Non-linearity	%F.S	0.03
Hysteresis	%F.S	0.03
Creep in 30 minutes	%F.S	0.03
Zero balance	%F.S	±1
Input resistance	Ω	385±5
Output resistance	Ω	350±3
Insulation resistance	MΩ	≥5000
Excitation voltage	V	10V (maximum 15V) AC/DC
Environmental protection		IP67
Safe overload	%F.S	150
Ultimate overload	%F.S	300
Operating temperature range	°C	-10~+40
Material		Alloy steel & Stainless steel
Cable Length	m	6

Wiring Schematic Diagram

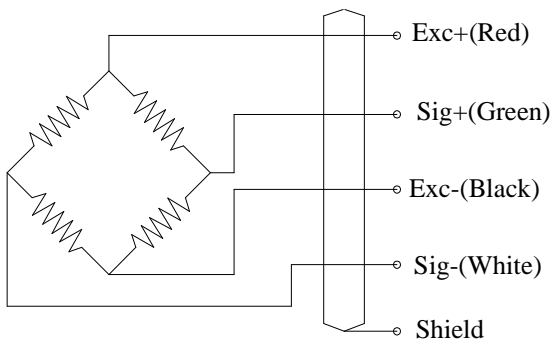

FEATURE

- Capacities 500lb~20Klb,250~5000kg
- Alloy tool steel construction
- Truck/Rail scales

AVAILABLE

- 6-wire circuit
- Digital
- Amplifier mode 4-20mA & 0-5V

INTERCHANGEABLE PRODUCTS

- VISHAY Model SQB/SQB-F