

MZ9 Sensor

Stainless steel rocker column load cell



DESCRIPTION

Stainless ball, argon-arc welded, high quality rubber coat between the load cell and support part to protect load cell precision from affected by impurities, be applicable to electric truck scales, railway scales, hopper and tank scales, etc.

OUTLINE DIMENSIONS in millimeters (mm)

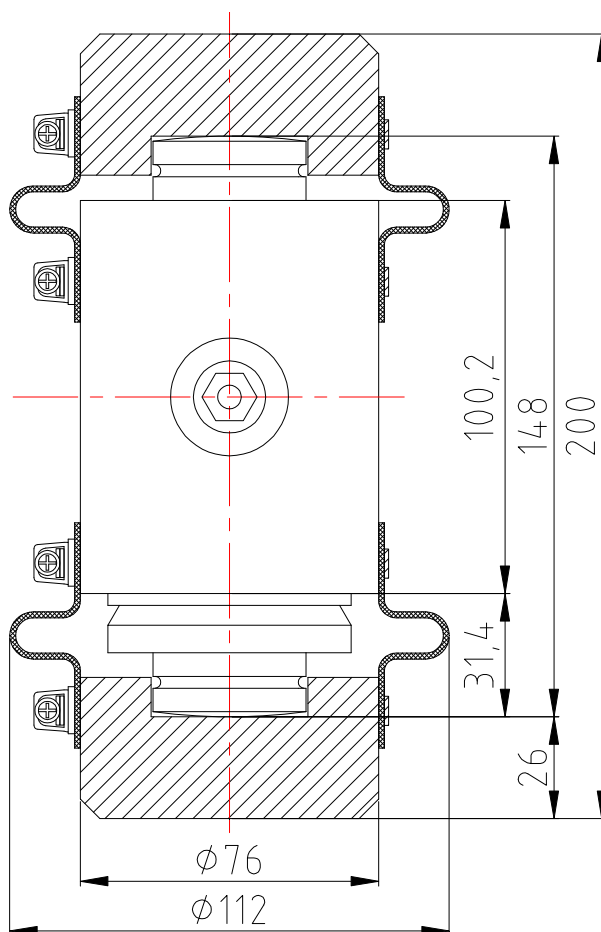

SPECIFICATIONS

Capacity	t	22.5, 45
Rated output	mv/v	2.0±0.1%
Non-linearity	%F.S	0.03
Hysteresis	%F.S	0.03
Creep in 30 minutes	%F.S	0.03
Zero balance	%F.S	±1
Input resistance	Ω	530±5
Output resistance	Ω	480±3
Insulation resistance	MΩ	≥5000
Excitation voltage	V	10V (maximum 15V) AC/DC
Environmental protection		IP67
Safe overload	%F.S	150
Ultimate overload	%F.S	300
Operating temperature range	°C	-10~+40
Material		Alloy steel & Stainless steel
Cable Length	m	15

Wiring Schematic Diagram

